



TYPE  
**5**



APARTMENT

# ASYLUM

**WITH ONE BEDROOM**

..... **48.43 m<sup>2</sup>**

A shelter for two people or a single, allowing you to cut yourself off from the world. A large bedroom and a spacious bathroom favor silence, and the kitchen and dining room, combined with the living room, is a space to spend time with your loved ones. One balcony for the entire width of the apartment is available both from the living room and from the bedroom.



APARTMENT  
**ASYLUM**

SURFACE OF  
THE APARTMENT:  
**48.43 m<sup>2</sup>**

BALCONY  
SURFACES:  
**BI 8.61 m<sup>2</sup>**

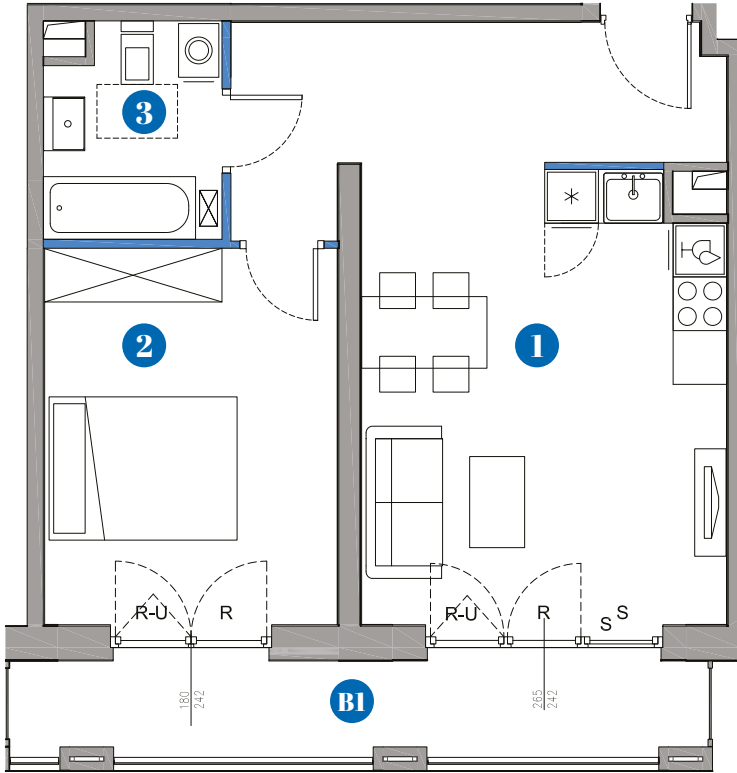

- 1** LIVING ROOM WITH A KITCHENETTE: **30.10 m<sup>2</sup>**
- 2** ROOM: **13.75 m<sup>2</sup>**
- 3** BATHROOM: **4.58 m<sup>2</sup>**

SCALE

UNREMOVABLE WALLS  
 WALLS POSSIBLE TO DEMOLITION

WINDOW NAMES:  
**R** – turn-only,  
**R-U** – tilt and turn,  
**S** – fixed

Surfaces calculated according to PN-ISO 9836, 2015  
Surfaces are subject to change  
Equipment for presentation purposes only, does not constitute a contractual obligation  
This project does not constitute an offer within the meaning of the Civil Code  
The height of the flat H = 275 cm, takes into account the finishing layers of the floor and ceiling  
In the kitchen, bathrooms and toilet, flush-mounted installations  
The flats will be equipped with mechanical exhaust ventilation

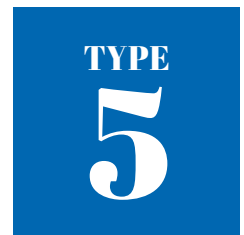

**FLOOR**

