

TYPE  
**1**



APARTMENT

# COMFORT

**THE LARGEST APARTMENT ON  
THE FIRST FLOOR**

..... **80.69 m<sup>2</sup>**

"Comfort" is the perfect apartment, for example for a family with two or three children, which helps to create a real home - filled with peace and love. Its space consists of three cozy bedrooms, a large bathroom and a separate toilet. The meeting place of the household was designed to fade out/mute and unite: the living room was combined with the dining room and kitchen. In addition this two large balconies, which invite you for a morning coffee.



APARTMENT

# COMFORT

SURFACE OF THE APARTMENT:  
**80.69 m<sup>2</sup>**

BALCONY SURFACES:  
**B1 5.99 m<sup>2</sup>**  
**B2 10.46 m<sup>2</sup>**

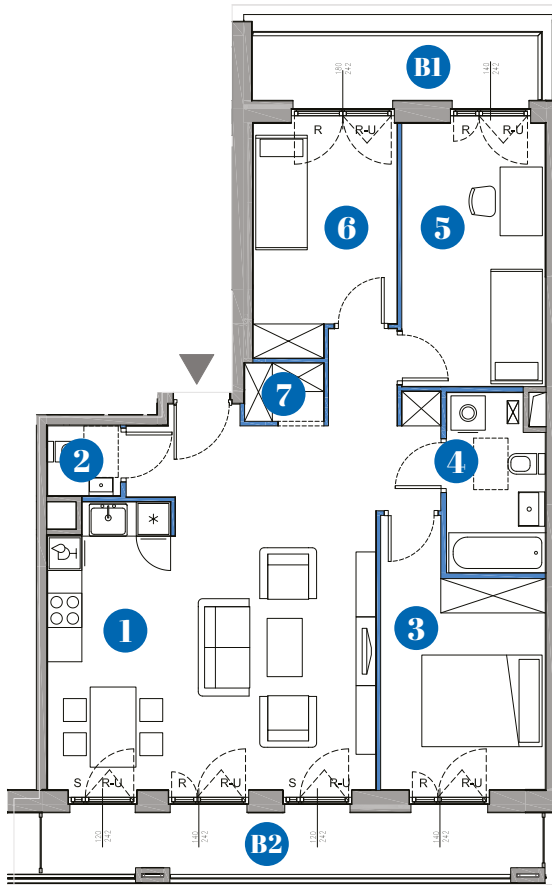

- 1** LIVING ROOM WITH A KITCHENETTE: **39.74 m<sup>2</sup>**
- 2** BATHROOM: **1.56 m<sup>2</sup>**
- 3** ROOM 1: **11.75 m<sup>2</sup>**
- 4** BATHROOM: **5.16 m<sup>2</sup>**
- 5** ROOM 2: **11.51 m<sup>2</sup>**
- 6** ROOM 3: **9.56 m<sup>2</sup>**
- 7** WARDROBE: **1.41 m<sup>2</sup>**

SCALE



UNREMOVABLE WALLS

WALLS POSSIBLE TO DEMOLITION

WINDOW NAMES:  
**R** - turn-only,  
**R-U** - tilt and turn,  
**S** - fixed

Surfaces calculated according to PN-ISO 9836, 2015

Surfaces are subject to change

Equipment for presentation purposes only, does not constitute a contractual obligation

This project does not constitute an offer within the meaning of the Civil Code

The height of the flat H = 275 cm, takes into account the finishing layers of the floor and ceiling

In the kitchen, bathrooms and toilet, flush-mounted installations

The flats will be equipped with mechanical exhaust ventilation

TYPE

**1**

## FLOOR

