



TYPE
3



APARTMENT

IDYLL

MEDIUM-SIZED FLAT

..... **41.53 m²**



Apartment that brings households closer together. The optimal size of the living room with kitchen and dining room favors long conversations at dinner and does not allow relatives to distance themselves from each other. Two balconies provide, if necessary, additional space for thought, and a large bathroom - moments of relaxation. It is perfect both for pairs and singles.



APARTMENT IDYLL

SURFACE OF THE APARTMENT:
41.53 m²

BALCONY SURFACES:
BI 6.61 m²

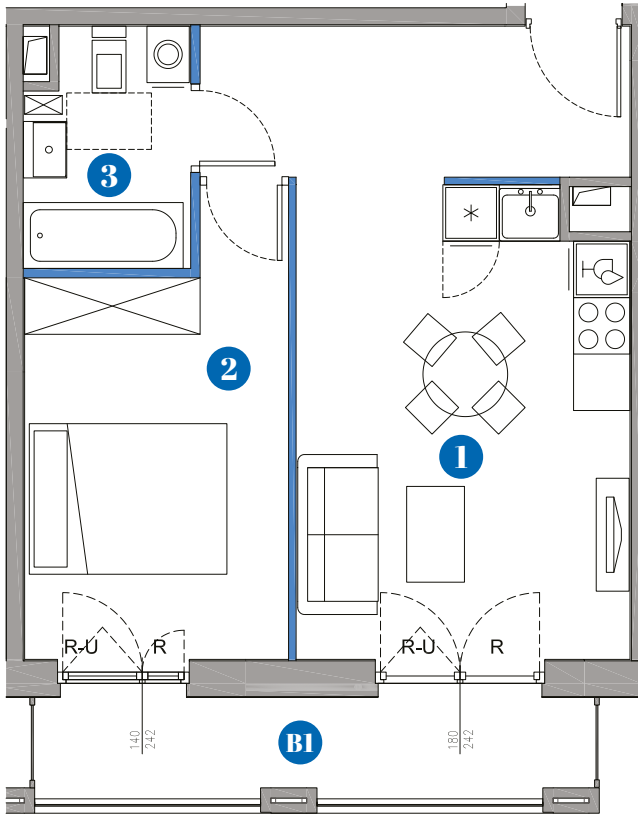

- 1** LIVING ROOM WITH A KITCHENETTE: **24.91 m²**
- 2** ROOM: **12.30 m²**
- 3** BATHROOM: **4.32 m²**

SCALE

UNREMOVABLE WALLS
 WALLS POSSIBLE TO DEMOLITION

WINDOW NAMES:
R - turn-only,
R-U - tilt and turn,
S - fixed

Surfaces calculated according to PN-ISO 9836, 2015
 Surfaces are subject to change
 Equipment for presentation purposes only, does not constitute a contractual obligation
 This project does not constitute an offer within the meaning of the Civil Code
 The height of the flat H = 275 cm, takes into account the finishing layers of the floor and ceiling
 In the kitchen, bathrooms and toilet, flush-mounted installations
 The flats will be equipped with mechanical exhaust ventilation

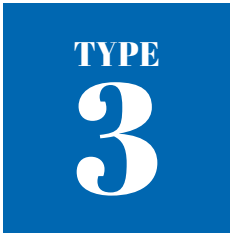

FLOOR

