



TYPE  
**7**



APARTMENT

# IMMENSITY

**PENTHOUSE WITH  
A GREAT VIEW**

..... **111.04 m<sup>2</sup>**

The "Immensity" penthouse has even more space for relaxation and meetings with relatives - it is approx. 100 m<sup>2</sup> located on the last floors of the building. In a huge living room connected to the kitchen, you can have a whole social life: with family and friends, with a glass of wine or a cup of hot tea. "Immensity" is a breathtaking view - through wide HS sliding windows from terraces or balconies.



APARTMENT

# IMMENSITY

SURFACE OF THE APARTMENT:

**111.04 m<sup>2</sup>**

BALCONY SURFACES:

**B1 11.40 m<sup>2</sup>**

**B2 8.14 m<sup>2</sup>**

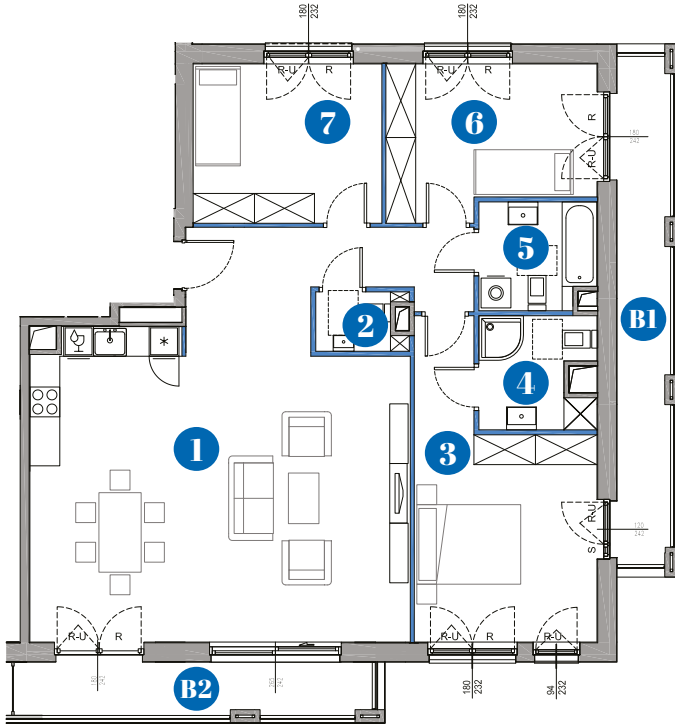

**1** LIVING ROOM WITH A KITCHENETTE: **56.46 m<sup>2</sup>**

**2** TOILET: **1.99 m<sup>2</sup>**

**3** ROOM 1: **18.20 m<sup>2</sup>**

**4** BATHROOM 1: **4.96 m<sup>2</sup>**

**5** BATHROOM 2: **4.96 m<sup>2</sup>**

**6** ROOM 2: **12.30 m<sup>2</sup>**

**7** ROOM 3: **12.17 m<sup>2</sup>**

SCALE



 UNREMOVABLE WALLS

 WALLS POSSIBLE TO DEMOLITION

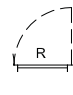
 WINDOW NAMES:  
**R** – turn-only,  
**R-U** – tilt and turn,  
**S** – fixed

Surfaces calculated according to PN-ISO 9836, 2015

Surfaces are subject to change

Equipment for presentation purposes only, does not constitute a contractual obligation

This project does not constitute an offer within the meaning of the Civil Code

The height of the flat H = 275 cm, takes into account the finishing layers of the floor and ceiling

In the kitchen, bathrooms and toilet, flush-mounted installations

The flats will be equipped with mechanical exhaust ventilation

TYPE

**7**

## 4<sup>TH</sup> FLOOR

