

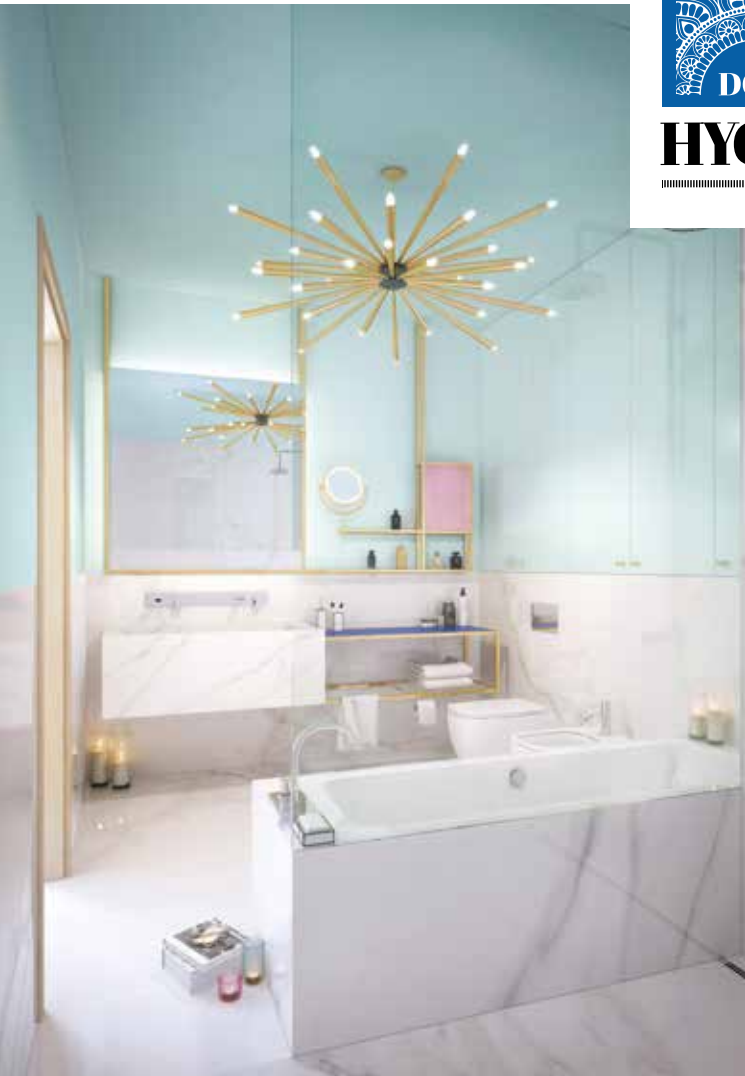

TYPE  
**4**



APARTMENT

# HARMONY

**A LARGE APARTMENT  
FOR THE FAMILY**

..... **73.80 m<sup>2</sup>**

In the large apartment "Harmony", the family will regain the balance between work and private life. The living room with an open kitchen and dining room allows you to enjoy the smallest moment. Two large bedrooms and one smaller provide each household with their own corner, and a balcony from the living room - a great view and a sense of freedom. The apartment has a large bathroom and a separate toilet.



APARTMENT

# HARMONY

SURFACE OF THE APARTMENT:

**73.80 m<sup>2</sup>**

BALCONY SURFACES:

**BI 4.38 m<sup>2</sup>**

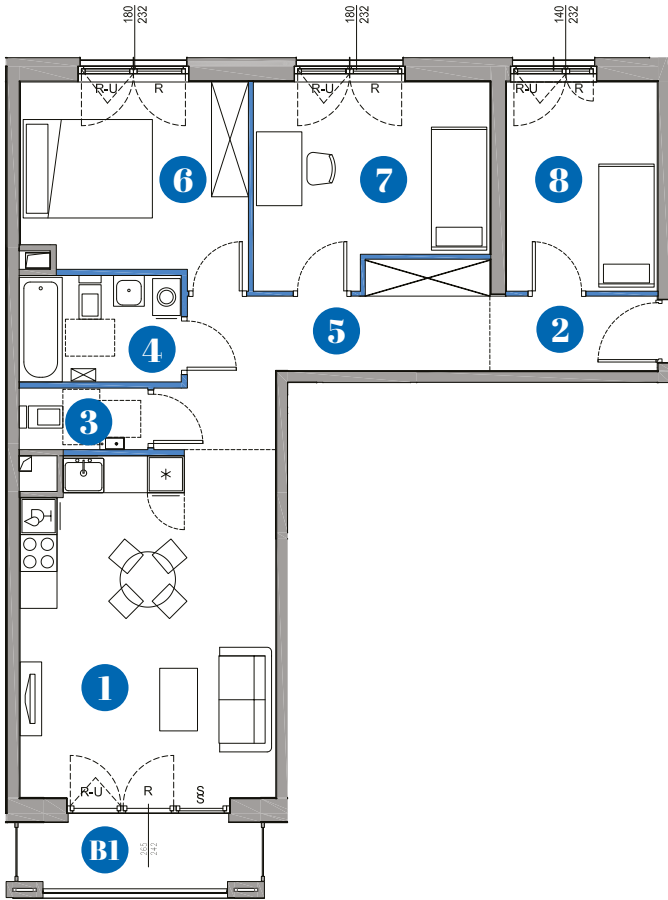

- 1** LIVING ROOM WITH A KITCHENETTE: **22.75 m<sup>2</sup>**
- 2** HALL: **3.29 m<sup>2</sup>**
- 3** TOILET: **2.09 m<sup>2</sup>**
- 4** BATHROOM: **4.56 m<sup>2</sup>**
- 5** CORRIDOR: **9.56 m<sup>2</sup>**
- 6** ROOM: **11.42 m<sup>2</sup>**
- 7** ROOM: **11.81 m<sup>2</sup>**
- 8** ROOM: **8.32 m<sup>2</sup>**

SCALE



UNREMOVABLE WALLS

WALLS POSSIBLE TO DEMOLITION

WINDOW NAMES:  
**R** – turn-only,  
**R-U** – tilt and turn,  
**S** – fixed

Surfaces calculated according to PN-ISO 9836, 2015

Surfaces are subject to change

Equipment for presentation purposes only, does not constitute a contractual obligation

This project does not constitute an offer within the meaning of the Civil Code

The height of the flat H = 275 cm, takes into account the finishing layers of the floor and ceiling

In the kitchen, bathrooms and toilet, flush-mounted installations

The flats will be equipped with mechanical exhaust ventilation

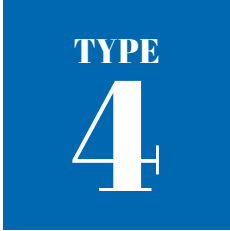

## FLOOR

